

# M2 OLED Digital Monitor

## QuickStart Installation Guide 1830 DC Multimeter w/SoC

### Components Included

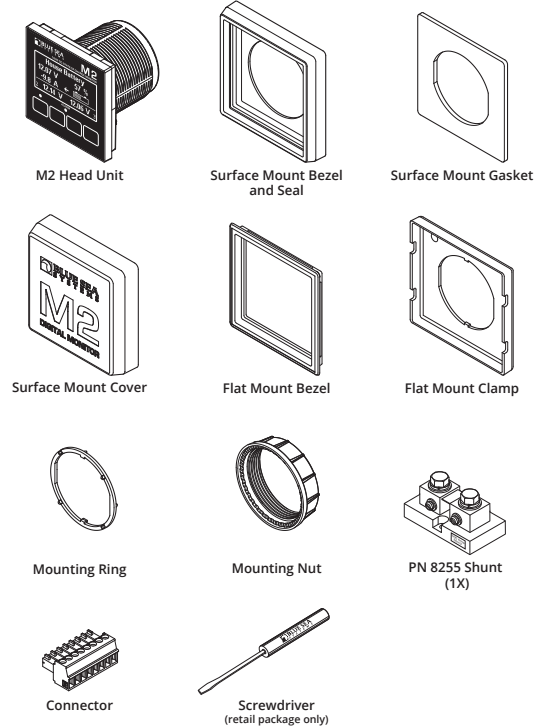

### 360 Panel Mounting Kit 1525 (sold separately)

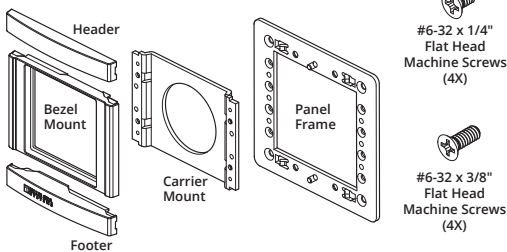

[blueseasystems.com/products/1830](http://blueseasystems.com/products/1830)

## Connector Pin Assignment

USB	Micro USB Port
8 Pin Connector*	Function
1 Required Connection	DC Negative
2 Required Connection	DC Supply/Battery 2 +
3	Relay Output
4	Relay Supply/Battery 3 +
5	Shunt 1 -
6	Shunt 1 +
7	Battery 1 -
8	Battery 1 +

\*The 8 pin low voltage connector supports wire sizes from 16-26 AWG

## M2 Meter Navigation

### Screen Menu Functions

Press any button to bring up the menu.

- After start-up, press any button to access the menu.
- Press the UP or DOWN arrow buttons to scroll through menu windows.
- Press the NEXT button to scroll right.
- To set alarms and for more detailed information, see the online manual at [blueseasystems.com/products/1830](http://blueseasystems.com/products/1830)

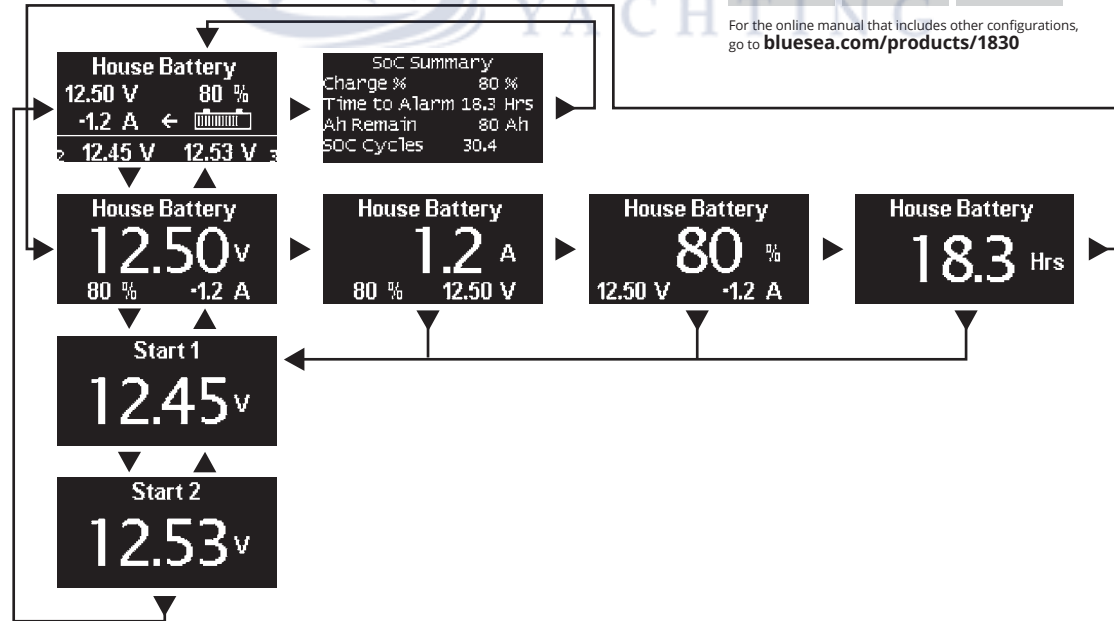

## System Overview

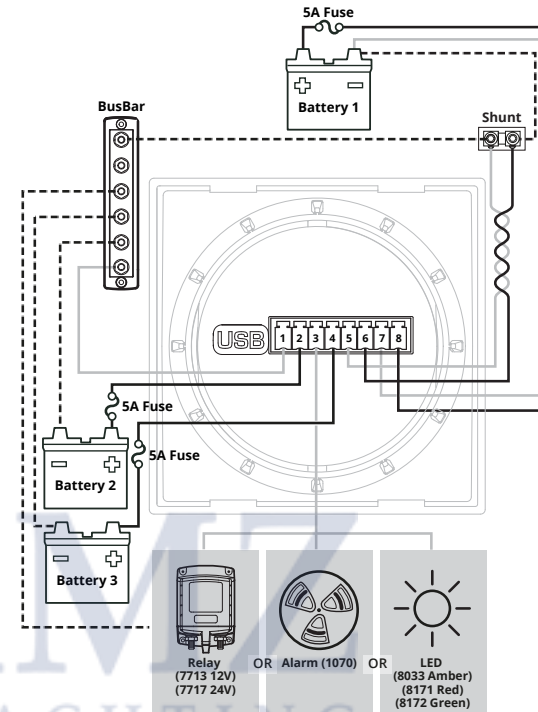

For the online manual that includes other configurations, go to [blueseasystems.com/products/1830](http://blueseasystems.com/products/1830)

## Installation Steps

- Choose meter mounting style and location.
- Prepare mounting hole using cutout templates.
- Using wiring diagram:
  - Install provided 500A/50mV Shunt.
  - Install busbar, if needed.
  - Make all connections to the meter's connector. Do not put fuses into fuse holders at this time.
- Plug wired connector into the meter.
- Insert fuses into fuse holders, making the fuse to Pin 2 (DC Supply/Battery 2+) Last.

## Basic Meter Setup

- Ensure Battery 1 (House Battery) is fully charged.
- Have Battery 1 information ready:
  - Battery Voltage: options are: 12V, 24V, 36V, or 48V
  - Battery Type: options are:
    - FLStd - Standard Flooded Acid Batteries
    - AGM - Standard AGM Batteries
    - TPPL - Thin Plate Pure Lead AGM Batteries
    - Gel - Gel Batteries
    - FLRsv - Flooded Acid Reserve
    - FLLoM - Flooded Low Maintenance, Sealed Flooded Acid Batteries.
    - CFoam - Carbon Foam AGM Batteries
    - Lilon - Lithium Ion Batteries.
  - Battery Capacity: Setting indicates the capacity of the battery in Amp-hours (Ah)
- Navigate to DC 1 Setup by going Menu>Setup>DC1 Setup.
- Enter information for Battery 1 from step 2
- Select Set SoC to Full. This resets the meter SoC to 99%.
- For information regarding Alarm Setup, Relay Setup, or Advanced SoC setups such as setting Charge parameters or using a different sized shunt, see the full instructions found at [blueseasystems.com/products/1830](http://blueseasystems.com/products/1830)



Click here for more information at [blueseasystems.com/products/1830](http://blueseasystems.com/products/1830)

# Mounting Options

# Mounting Templates

## Flat Mount

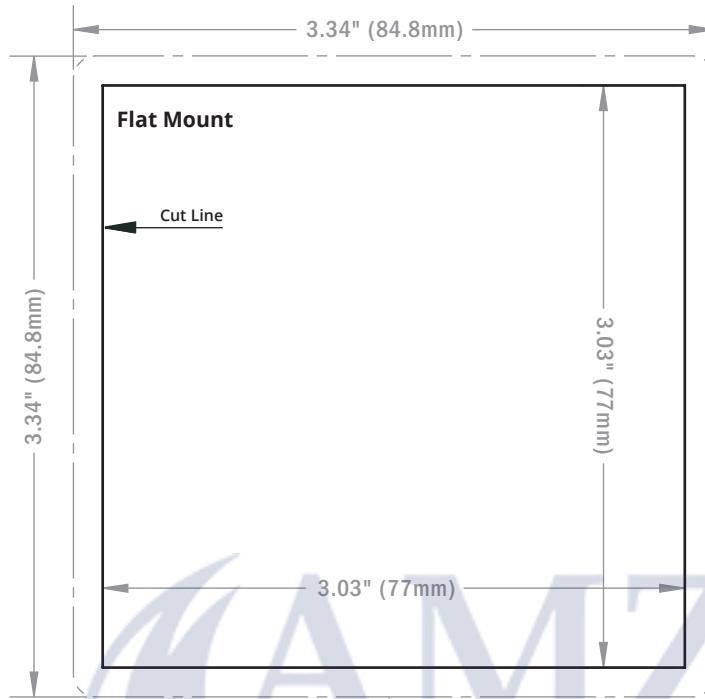
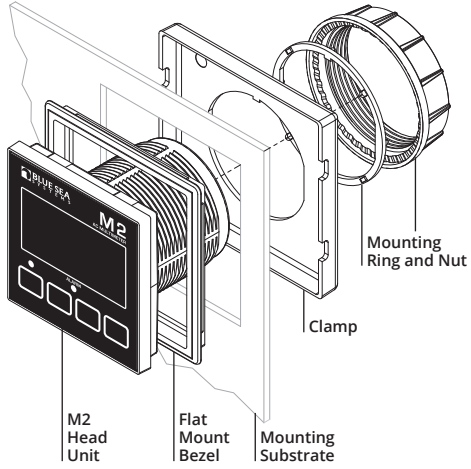

## Surface Mount

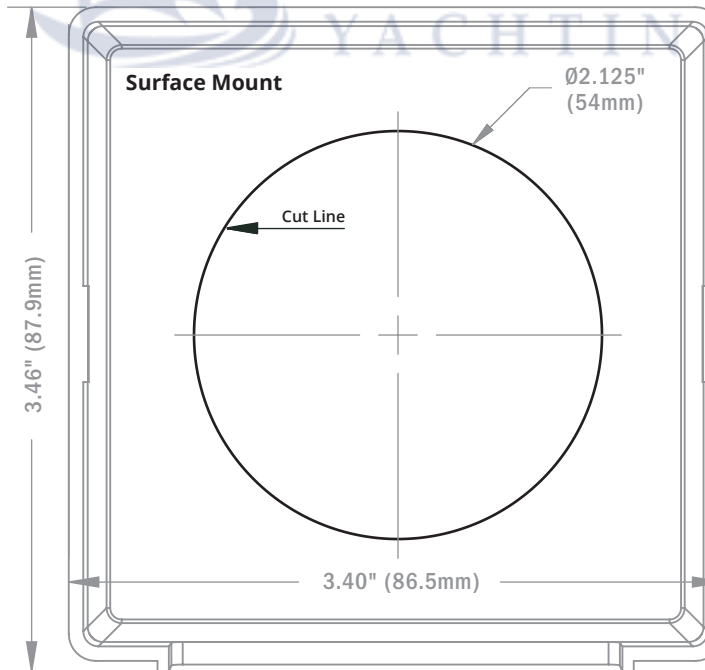
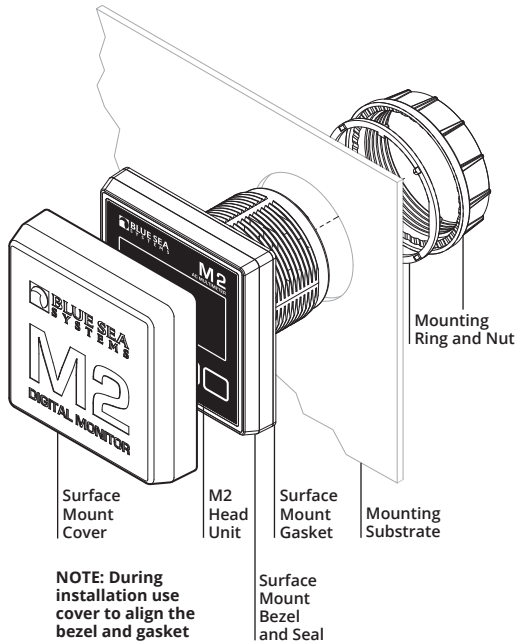

### ⚠ WARNING

The WARNING symbol refers to possible injury to the user or significant damage to the monitor if the user does not follow the procedures.

### ⚠ CAUTION

The CAUTION symbol refers to restrictions and rules with regard to preventing damage.

### ⚠ WARNING

- ☑ If you are not knowledgeable about electrical systems, have an electrical professional install this unit. The diagrams in these instructions pertain to the installation of the unit and not to the overall wiring of the vessel.
- ☑ Verify that no other DC or AC sources are connected to the vessel's wiring before installing the unit.

### ⚠ CAUTION

- ☑ The back of the unit is not waterproof. Do not install where the back of the monitor is exposed to water.

## Warranty

The M2 OLED Digital Meters come with a 5 year manufacturer's warranty. This means the meter is warranted to be free from defects in materials or workmanship for 5 years from the date of first purchase. The warranty is limited solely to the cost of repair or replacement of the M2 Meter product. Costs associated with labor or shipping of the defective parts are not covered. Blue Sea Systems cannot accept liability for damage due to the misuse of the M2 Meter.